



**Supplier of Metal Identification
Plates and Tags**

● Rectangular Tags



Manufacturing Specifications

- Guaranteed for automatic feed
- Burr requirements - .0025" or less
- Oil free packaging
- Packaged to optimize feed ability
- American sourced material
- All tags are die cut

10 Standard

Size = 1.562" x 3.5"

Hole & Slot Options

# 000 = no holes	# 125 = (1) .250" hole	# 225 = (2) .250" holes
# 112 = (1) .125" hole	# 137 = (1) .375" hole	# 1LG = (1) .125" x .500" slot
# 115 = (1) .156" hole	# 212 = (2) .125" holes	# 4RL = (4) .062" x .400" slots
	# 215 = (2) .156" holes	

13

Size = 1.575" x 3.15"

Hole Options

000 = no holes
115 = (1) .156" hole
215 = (2) .156" holes

11

Size = 1" x 3.5"
(rolled edge)

Hole Options

125 = (1) .250" hole
000 = no holes

25

Size = 3.5" x 2"

Hole Options

000 = no holes
115 = (1) .156" hole
215 = (2) .156" holes

12

Size = 1.062" x 3.5"

Small Standard

Hole & Slot Options

# 115 = (1) .156" hole	# 000 = no holes
# 125 = (1) .250" hole	# 215 = (2) .156" holes
# 137 = (1) .375" hole	# 225 = (2) .250" holes
	# 420 = (4) .200" holes
	# 4RL = (4) .062" x .400" slots

31 Size = 2.125" x 3.375" CR80

Hole & Slot Options

# 000 = no holes	# 150 = (1) .500" hole
# 115 = (1) .156" hole	# 215 = (2) .156" holes
# C18 = (1) .188" hole (in corner)	# 225 = (2) .250" holes
# C20 = (1) .203" hole (in corner)	# 415 = (4) .156" holes
# 125 = (1) .250" hole (centered)	# 1LG = (1) .125" x .500" slot
	# 2TN = (2) .188" x .063" slots

38

Size = 1.53" x 2.69"

Hole Options

#000 = no holes	#115 = (1) .156 hole
#112 = (1) .125 hole	#212 = (2) .125 holes
	#215 = (2) .156 holes

32

Size = 1.725" x 3.5"

CR50

Hole Options

# 000 = no holes	# 118 = (1) .188" hole
# 115 = (1) .156" hole	# 215 = (2) .156" holes
	# 218 = (2) .188" holes

51

Size = 1.874" x 2.425"

Hole Options

000 = no holes
115 = (1) .156" hole

33

Size = 1.725" x 3.5"

CR50

Hole & Slot Options

# 000 = no holes	# 209 = (2) .093" holes
# 109 = (1) .093" hole	# 215 = (2) .156" holes
# 115 = (1) .156" hole	# 221 = (2) .216" holes
# 118 = (1) .188" hole	# 225 = (2) .250" holes
# 125 = (1) .250" hole	# 420 = (4) .200" holes
# 128 = (1) .281" hole	# 425 = (4) .250" holes
# 150 = (1) .500" hole	# 2TN = (2) .188" x .063" slots

24

Size = 1" x 2"

Hole Options

000 = no holes
115 = (1) .156" hole
121 = (1) .218" hole
215 = (2) .156" holes

V6

Size =
1.25" X
(up to) 6"
(variable length tag)

Medical Size
1.25" x 2.25"

Medical ID Plate

Hole Options

114 = (1) .140" hole
215 = (2) .156" holes
425 = (4) .250" holes
000 = no holes

34

Size = 2" x 3"

Hole & Slot Options

# 000 = no holes	# 1LG = (1) .125" x .500" slot
# 112 = (1) .125" hole	# 2LG = (2) .125" x .500" slots
# 212 = (2) .125" holes	
# HLG = (1) .125" x .500" luggage slot	

35

Size = 1.1" x 2.25"

Hole Options

#000=no holes
#112=(1) .125 hole
#212=(2) .125 holes
#425=(4) .250 holes

93

Size =

1.299" x 1.457"
(33mm x 37mm)

Hole Options

000 = no holes
122 = (1) .220" hole

23

Size = .809" x 1.21"

Hole Options

112 = (1) .125" hole
000 = no holes

94

Size =
.75" x 1.5"

Hole Options

000 = no holes
112 = (1) .125" hole
128 = (1) .281" hole

● Rectangular Tags

65

Size = 2.875" x 4"

Hole Options

- # 000 = no holes
- # 115 = (1) .156" hole
- # 118 = (1) .188" hole (centered on 4" side)
- # 215 = (2) .156" holes
- # 415 = (4) .156" holes

68

Size = 2.82" x 3.75"

Hole Options

- # 000 = no holes
- # 115 = (1) .156" hole
- # 125 = (1) .250" hole
- # 215 = (2) .156" holes
- # 225 = (2) .250" holes
- # 415 = (4) .156" holes

V5

Size = 2" x 4"

Hole Options

- # 000 = no holes
 - # 415 = (4) .156" holes
- (variable length tag)

Size = 4" tall - up to 8" in length

Size = 6" x 4"

Size = 7" x 4"

Size = 8" x 4"

(image not to scale)

14

Size = .68" x 3.3"

Hole Options

- # 000 = no holes
- # 112 = (1) .125" hole
- # 212 = (2) .125" holes

36

Size = .625" x 3.313"

Hole & Slot Options

- # 000 = no holes
- # 112 = (1) .125" hole
- # 212 = (2) .125" holes
- # 4RL = (4) .062" x .400" slots

● Strip / Cable Tags

- Guaranteed for automatic feed
- Ideal for rapid embossing
- Scored for easy separation

- VIN plates
- Cable identification
- Hydraulic hose identification

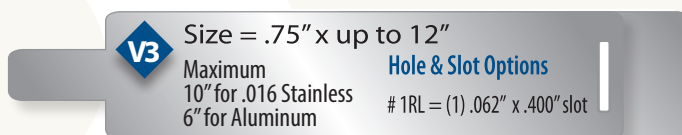
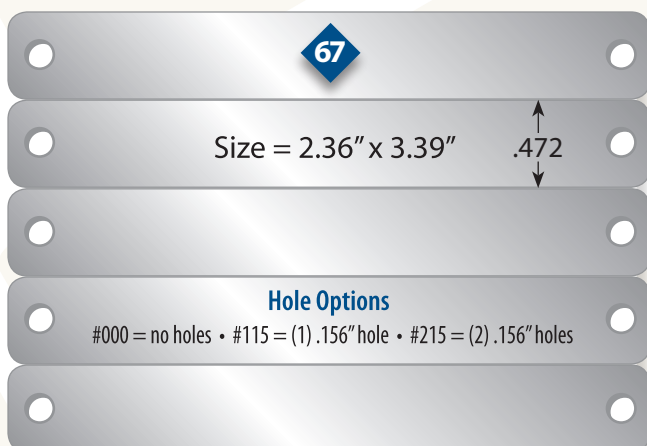
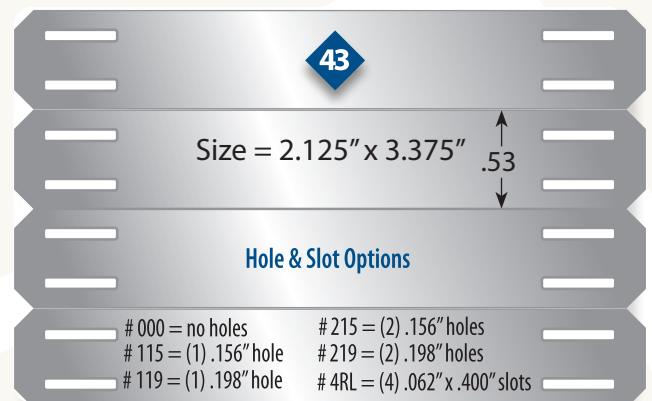
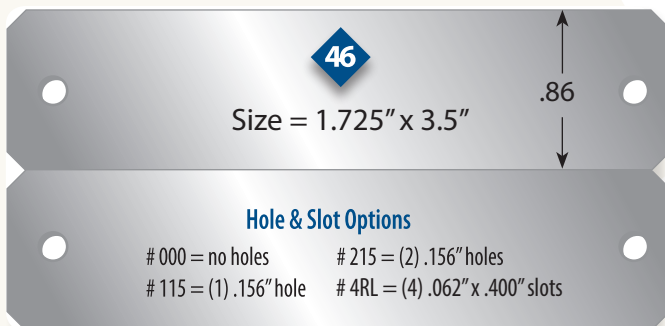
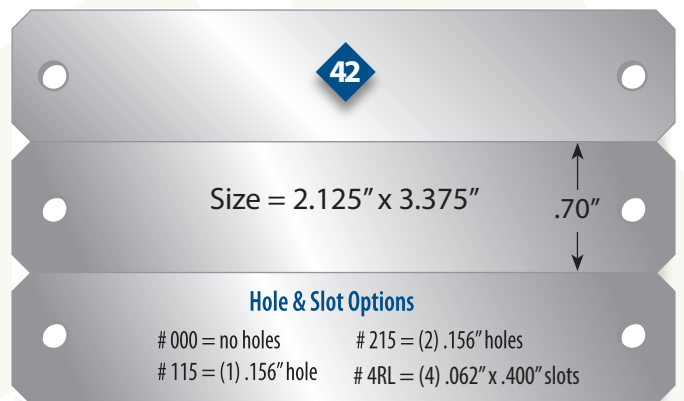
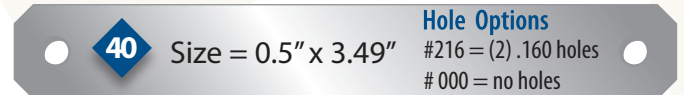
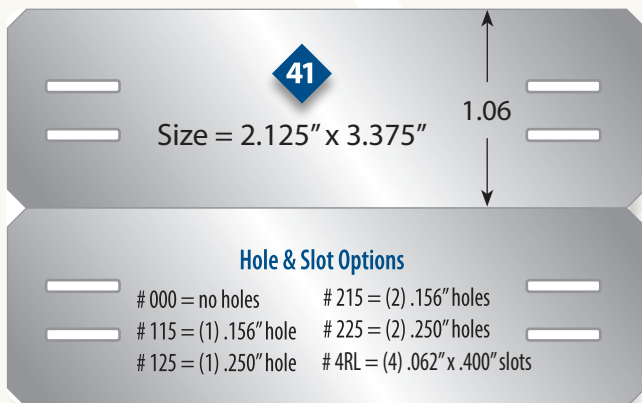

(variable length tag)

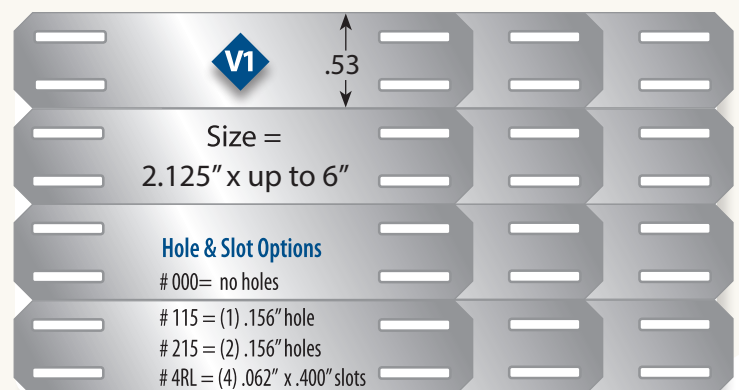

(variable length tag)

● Round & Octagonal Tags

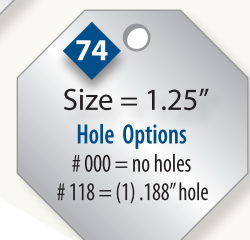
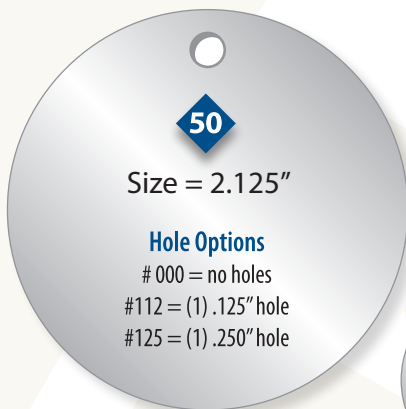

Round Tags

- Ideal for valve marking
- Available in a variety of colors

Octagonal Tags

- Designed for embossing
- Available in a variety of colors

● Dog Tags

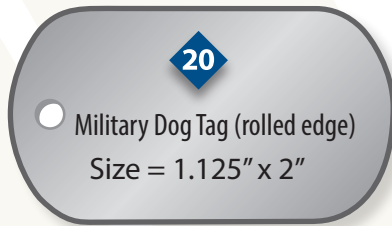

- 1 - #214 = (2) .140" holes
- 2 - #114 = (1) .140" hole
- 3 - #2RL = (2) .062" x .400" slots
- 4 - #000 = no holes

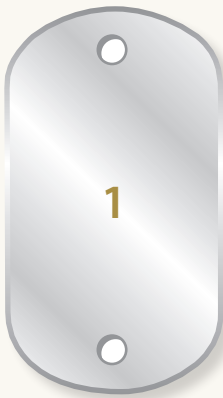

- Available in stainless steel (bright and dull), brass and copper
- Manufactured to military specifications
- Not available in anodized colors

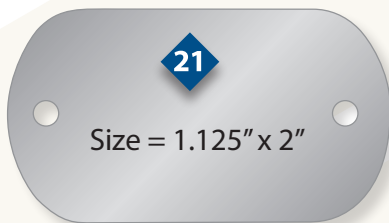

Hole Options

- # 000 = no holes
- # 112 = (1) .125" hole
- # 125 = (1) .250" hole
- # 212 = (2) .125" holes

Anodized Colors

Light Blue - LB

Clear = CL

Green = GR

Red = RD

Orange = RG

Blue = BL

Violet = VT

Black = BK

Yellow = YL

Silicone Rubber Silencers for Military Dog Tags



Dog Tag Chains



Chains available in nickel plated
or stainless steel in 4.5", 24" & 30"
lengths

Laser engraved business cards on #31 and #25 tag



Please call for all embossed, silk screen or laser engraved applications



Most Popular Stocked Tags- Shown with Typical Hole Configurations



10 / Standard Tag

- Part # 10304DD5215 (stainless steel with 2 –5/32" holes).
- Part # 10A30ML6215 (mill finished aluminum with 2 –5/32" holes).

Stainless Steel (.015") @ 500 per box 11.7 pounds each

Aluminum (.016") @ 1000 per box - 8.7 pounds each.

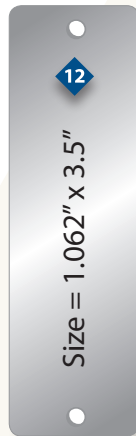

12 / Small Standard Tag

- Part # 12304DD5215 (stainless steel with 2 –5/32" holes).
- Part # 12A30ML6215 (mill finished aluminum with 2 –5/32" holes).

Stainless Steel (.015") @ 1000 per box 15.8 pounds each

Aluminum (.016") @ 1000 per box - 6.3 pounds each.

These tag images are not to scale



21 / Military Dog Tag

- Part # 21A50XXJ112 (anodized aluminum with 1 –1/8" hole).

This is also very popular in .032" in various colors with one or two holes. (blue, black, green, yellow, red, orange & violet)

Aluminum (.032") @ 500 per box 3.6 - pounds each.



31 / CR80 Tag

- Part # 31304DD5215 (stainless steel with 2 –5/32" holes).
- Part # 31A30ML6215 (mill finished aluminum with 2 –5/32" holes).

Stainless Steel (.015") @ 500 per box 15.2 pounds each.

Aluminum (.016") @ 1000 per box - 11.5 pounds each.

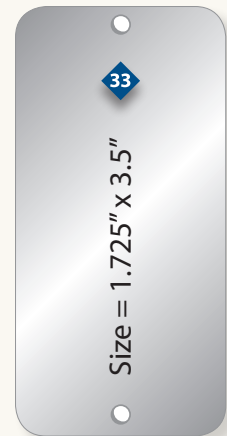

33/ CR50 Tag

- Part # 33304DD5215 (stainless steel with 2 –5/32" holes).
- Part # 33A30ML6215 (mill finished aluminum with 2 –5/32" holes).

This tag is popular because of the larger radius corners, and a little smaller than the "31" tag. This came from the Sears credit card size and is called a "CR50" tag.

Stainless Steel (.015") @ 500 per box 13.7 pounds each.



34 / Small Standard Tag

- Part # 34A30ML6215 (mill finished aluminum with 2 –5/32" holes .016" thick).

This is also very popular in .032" (part # 34A50XXJ000) in various colors with no holes. (blue, black, green, yellow, red).

Aluminum (.016") @ 500 per box 5.1 pounds each.

Aluminum (.032") @ 500 per box 10.3 pounds each.



43 / Scored Tag

- Part # 43A30ML64RL (mill finished aluminum with 4 –.062" x .400" slots).

Designed to be embossed / marked first, and then to be broken into four strips. Used to identify cabling, hoses etc. on ships, aircraft and heavy equipment. Available in a variable length tag as well as one score and two score options.

Aluminum (.016") @ 1000 per box 11.0 pounds each.



43 / Scored Tag

Paint Mask Label for scored tag, label is easily removed on the job site after embossed and painted.

- Part # 43A30WL64RL (mill finished aluminum with 4 –.062" x .400" slots .016" thick). Available in a two score tag as well.

3M 7600 White Vinyl Labels

Face stock: 3.8 mils, soft gloss white, topcoat vinyl.

Adhesive: 3M Removable R3600

With Paint Mask Label Applied



20 / Military Dog Tag

- Part # 20304DD4114 (304 stainless steel with a .140" hole and rolled edge)

This is also very popular for promotional use, military use and product marking.

Stainless Steel (.014") @ 100 per box 1 pound each.

#10 Hole and Slot Options

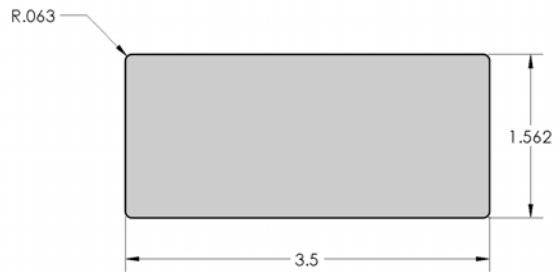

Hole Code **000**: No Holes

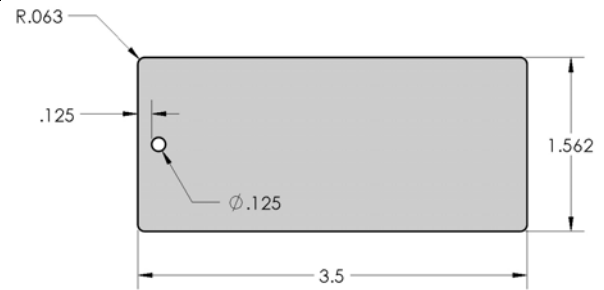

Hole Code **112**: (1) .125"Ø Hole

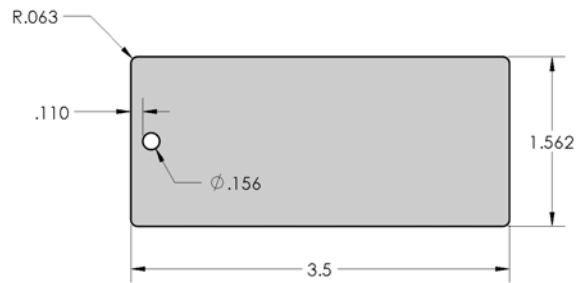

Hole Code **115**: (1) .156"Ø Hole

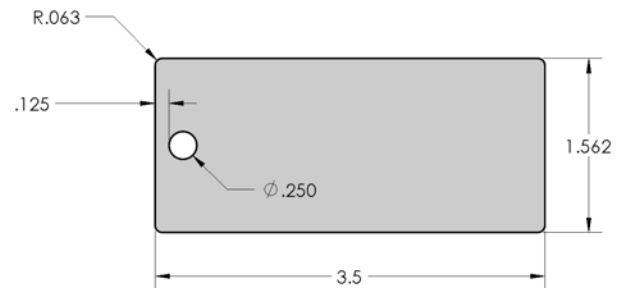

Hole Code **125**: (1) .250"Ø Hole

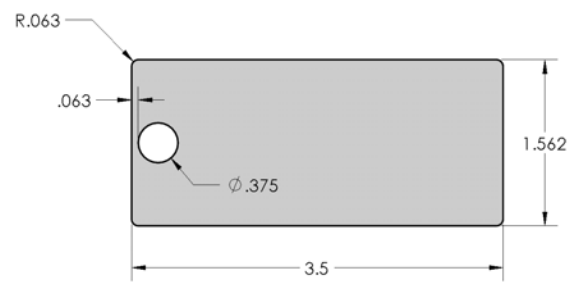

Hole Code **137**: (1) .375"Ø Hole

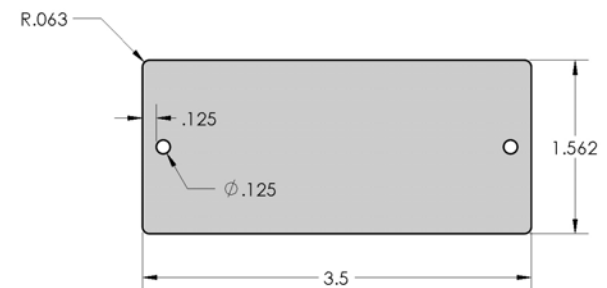

Hole Code **212**: (2) .125"Ø Holes

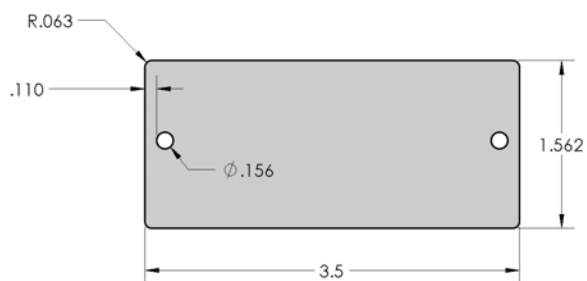

Hole Code **215**: (2) .156"Ø Holes

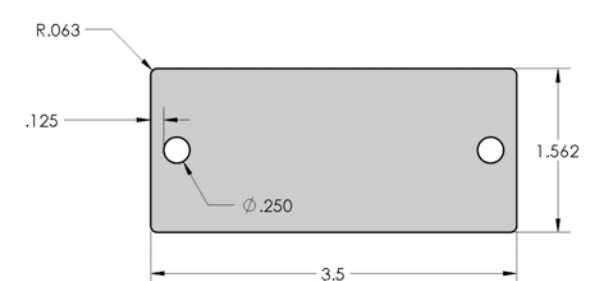

Hole Code **225**: (2) .250"Ø Holes

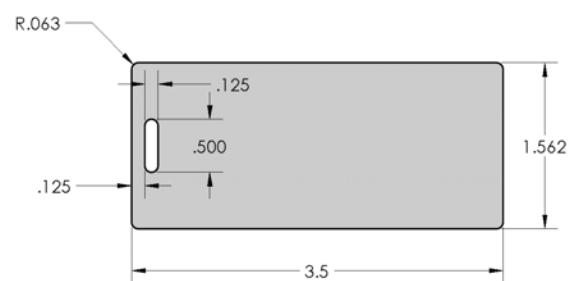

Hole Code **1LG**: (1) .125" x .500" Slot

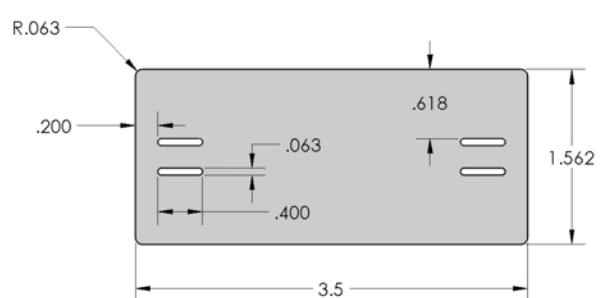

Hole Code **4RL**: (4) .062" x .400" Slots

#12 Hole and Slot Options

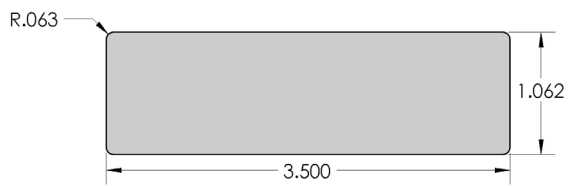

Hole Code **000**: No Holes

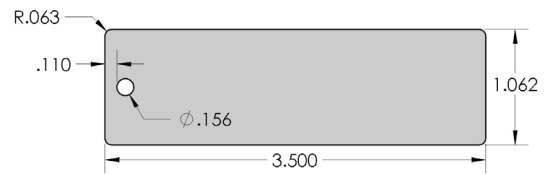

Hole Code **115**: (1) .156" \varnothing Hole

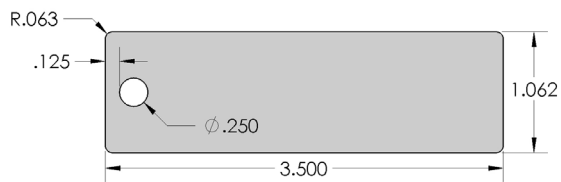

Hole Code **125**: (1) .250" \varnothing Hole

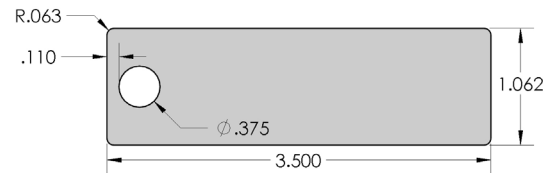

Hole Code **137**: (1) .375" \varnothing Hole



Hole Code **215**: (2) .156" \varnothing Holes

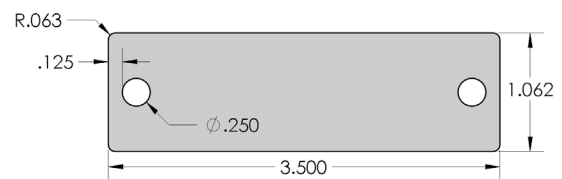

Hole Code **225**: (2) .250" \varnothing Holes

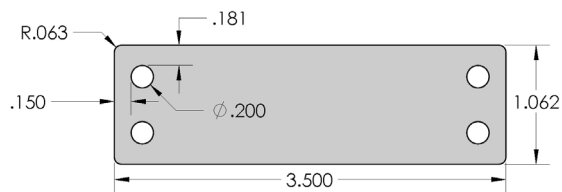

Hole Code **420**: (4) .200" \varnothing Holes

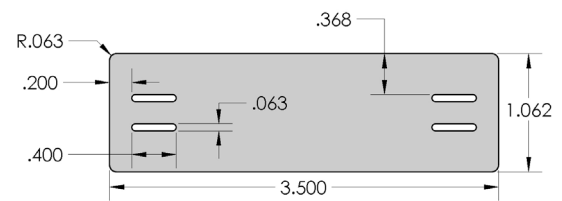

Hole Code **4RL**: (4) .062" x .400" Slots

#21 Hole and Slot Options

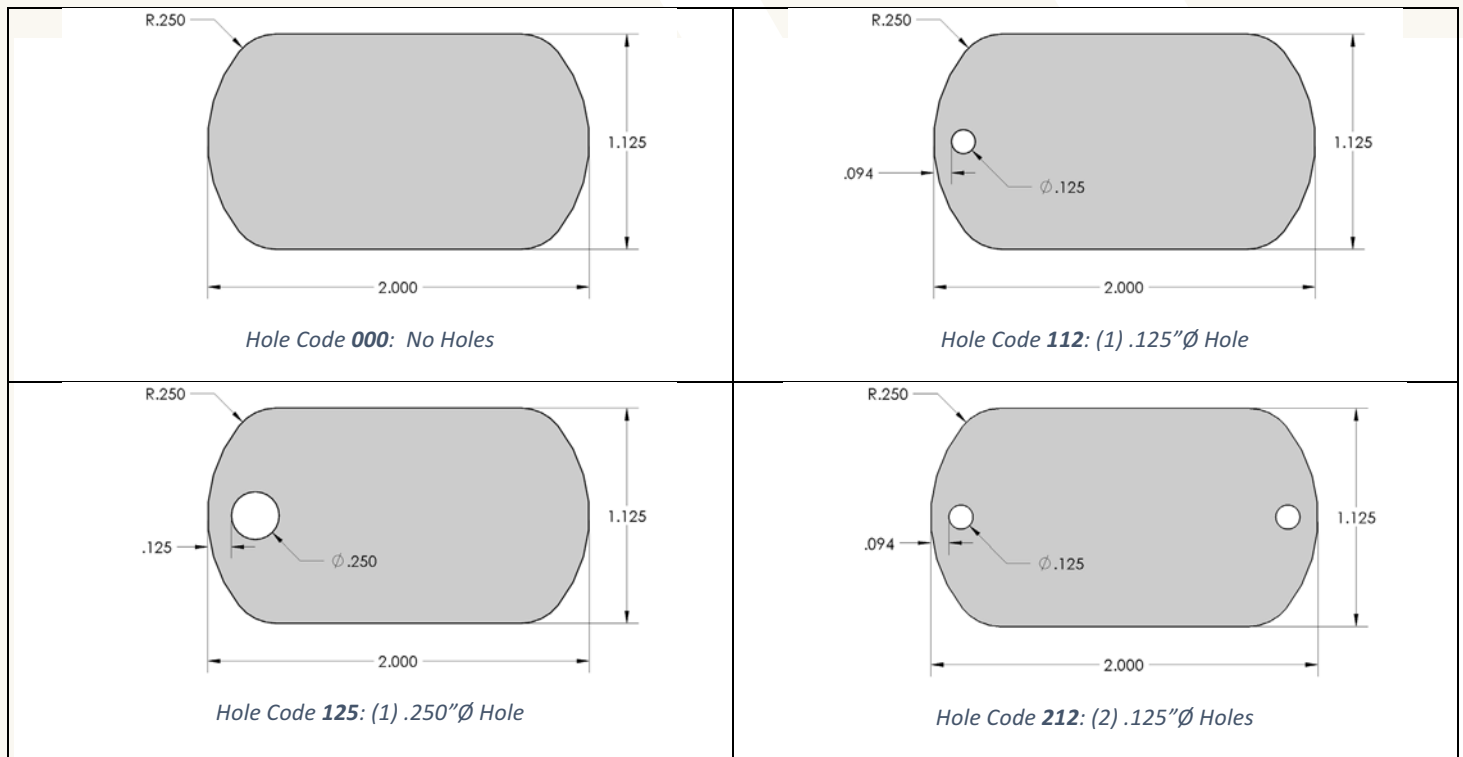

#31 Hole and Slot Options

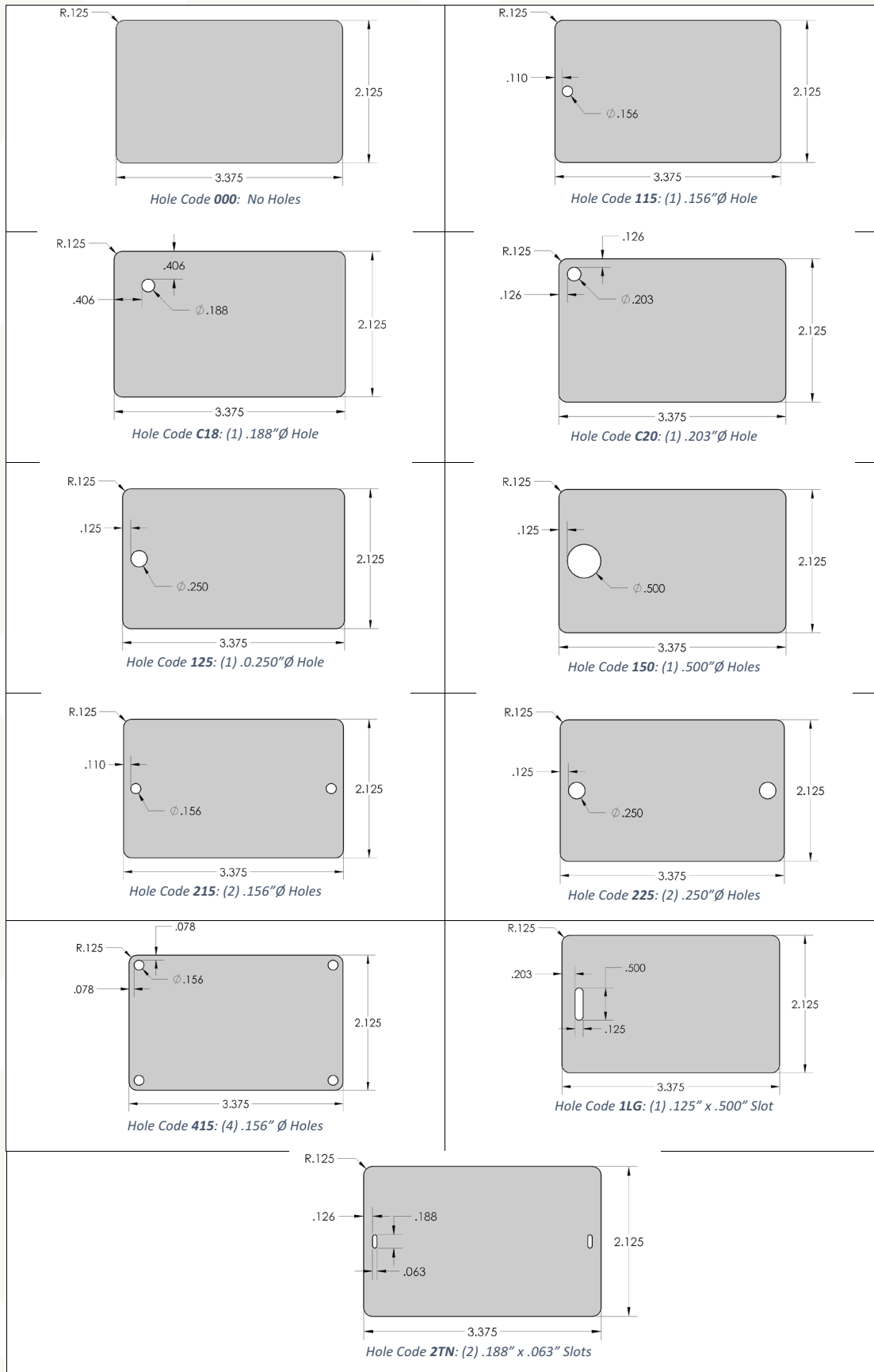

#33 Hole and Slot Options

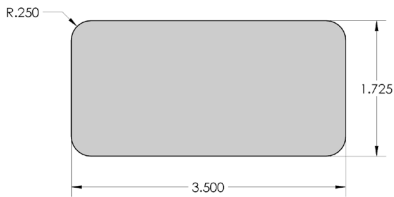
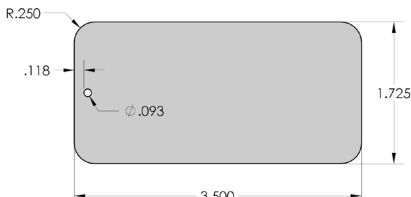
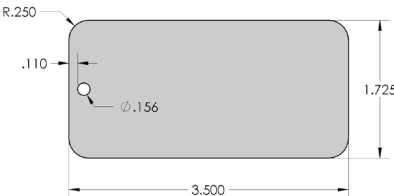
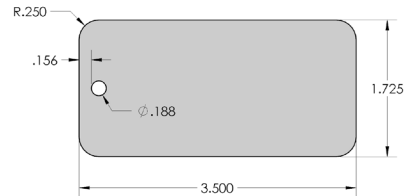
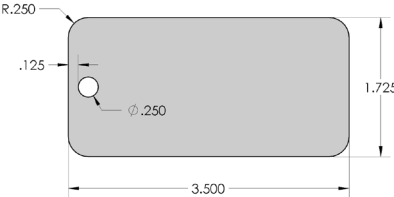
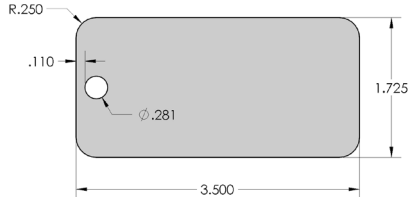
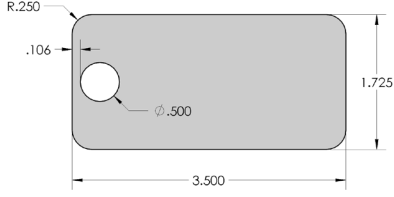
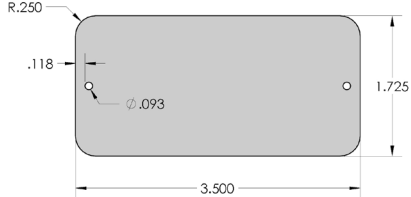
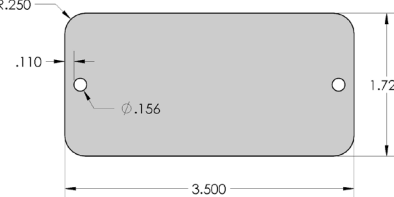
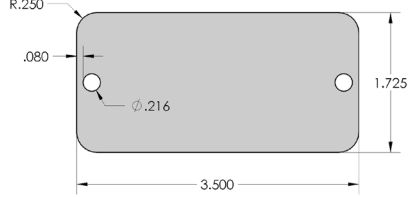
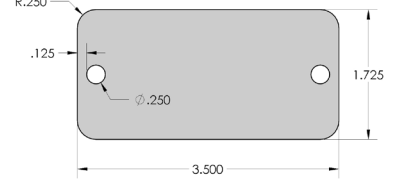
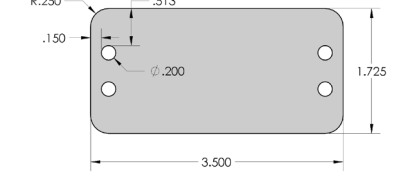
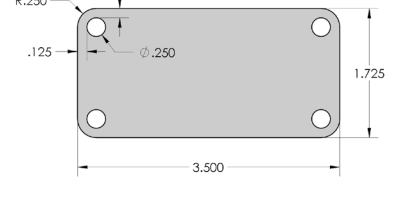
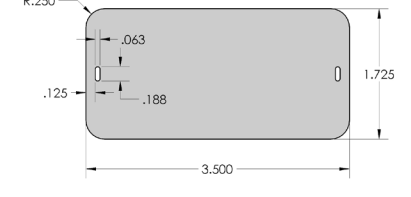
 <p>Hole Code 000: No Holes</p>	 <p>Hole Code 109: (1) .093" \varnothing Hole</p>
 <p>Hole Code 115: (1) .156" \varnothing Hole</p>	 <p>Hole Code 118: (1) .188" \varnothing Hole</p>
 <p>Hole Code 125: (1) .250" \varnothing Hole</p>	 <p>Hole Code 128: (1) .281" \varnothing Holes</p>
 <p>Hole Code 150: (1) .500" \varnothing Holes</p>	 <p>Hole Code 209: (2) .093" \varnothing Holes</p>
 <p>Hole Code 215: (2) .156" \varnothing Holes</p>	 <p>Hole Code 221: (2) .216" \varnothing Holes</p>
 <p>Hole Code 225: (2) .250" \varnothing Holes</p>	 <p>Hole Code 420: (4) .200" \varnothing Holes</p>
 <p>Hole Code 425: (4) .250" \varnothing Holes</p>	 <p>Hole Code 2TN: (2) .188" x .063" Slots</p>

#34 Hole and Slot Options

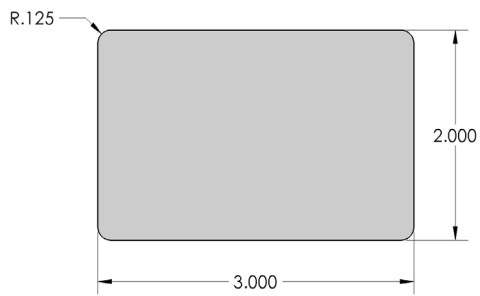

Hole Code **000**: No Holes

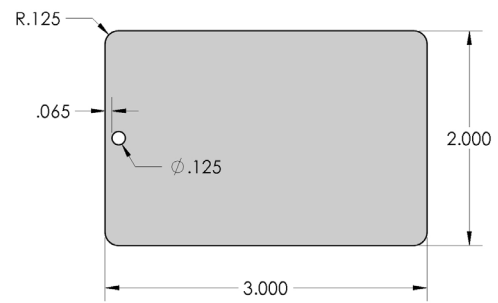

Hole Code **112**: (1) .125" ϕ Hole

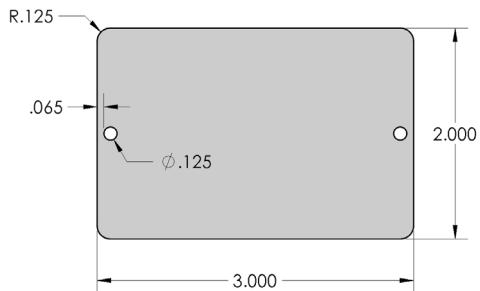

Hole Code **212**: (2) .125" ϕ Holes

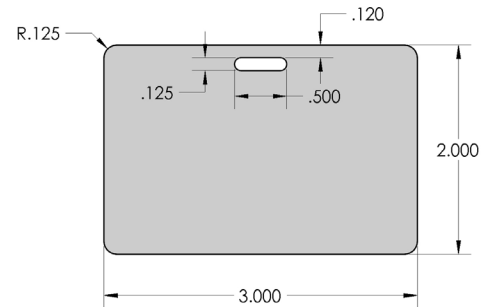

Hole Code **HLG**: (1) .125" x .500" Luggage Slot

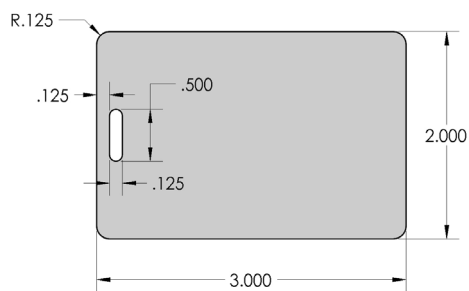

Hole Code **1LG**: (1) .125" x .500" Slot

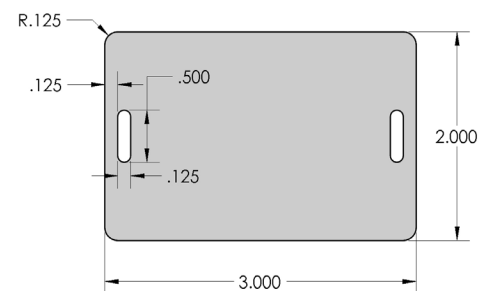

Hole Code **2LG**: (2) .125" x .500" Slots

#43 Hole and Slot Options

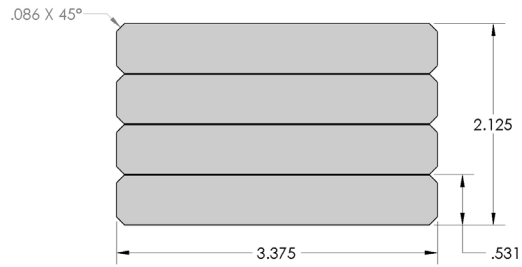

Hole Code 000: No Holes

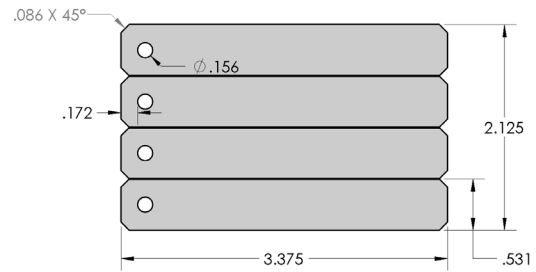

Hole Code 115: (1) .156"Ø Hole

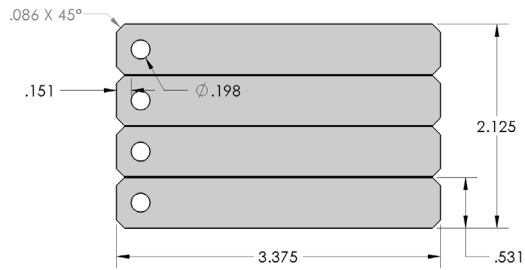

Hole Code 119: (1) .198"Ø Hole

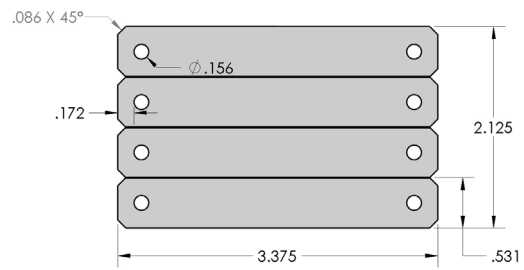

Hole Code 215: (2) .156"Ø Holes

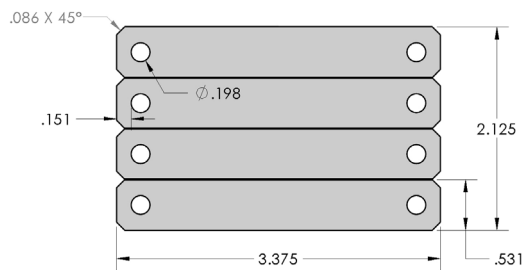

Hole Code 219: (2) .198" Holes

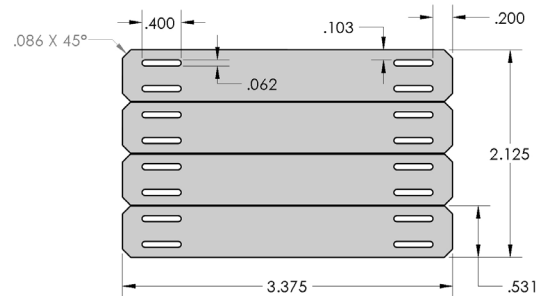

Hole Code 4RL: (4) .062" x .400" Slots

Sample Sheet for Ordering

1 - Tag Part Number

Number	Dimensions
10	1.56" X 3.5"
11	1.00" X 3.50"
12	1.06" X 3.50"
13	1.57" x 3.15"
14	.680" X 3.30"
20	1.12" X 2.00"
21	1.12" X 2.00"
23	.809" X 1.21"
24	1.00" x 2.00"
25	2.00" x 3.50"
31	2.12" X 3.37"
32	1.72" X 3.50"
33	1.72" X 3.50"
34	2.00" X 3.00"
35	1.10" X 2.25"
36	.620" X 3.31"
37	1.37" X 3.75"
38	1.53" X 2.69"
40	.500" x 3.49"
41	2.12" X 3.37"
42	2.12" X 3.37"
43	2.12" X 3.37"
46	1.72" X 3.50"
50	2.12" Round
51	1.87" x 2.42"
53	1.50" Round
54	1.00" Round
65	2.87" X 4.00"
67	2.36" X 3.39"
68	2.82" X 3.75"
74	1.25" Hex
75	1.50" Hex
93	1.45" x 1.29"
94	.750" x 1.50"

2 - Material

Ordering Code	Material and Thickness and Description
A30ML0	Mill finish 3003 Aluminum, .010" thick
A30ML6	Mill finish 3003 Aluminum, .016" thick
A30MLE	Mill finish 3003 Aluminum, .025" thick
A30MLJ	Mill finish 3003 Aluminum, .032" thick
A50CL6	Clear anodized 5005 Aluminum, .016" thick
A50CLJ	Clear anodized 5005 Aluminum, .032" thick
A50XX6*	Anodized 5005 Aluminum, .016" thick (* replace XX with <i>color code</i>)
A50XXJ*	Anodized 5005 Aluminum, .032" thick (* replace XX with <i>color code</i>)
A50RDE	Anodized 5005 Aluminum, .025" thick
A52XXA*	Anodized 5205 Aluminum, .020" thick, Black and Dark Bronze Only
A50XXJ*	Anodized 5205 Aluminum, .032" thick , Black and Dark Bronze Only
260ML6	Mill finish 260 Cartridge Brass, .016" thick
260MLJ	Mill finish 260 Cartridge Brass, .032" thick
304DD2	Dull finish 304 Stainless Steel, .010" thick
304DD4	Dull finish 304 Stainless Steel, .014" thick
304DD5	Dull finish 304 Stainless Steel, .015" thick
316DD5	Dull finish 316 Stainless Steel, .015" thick
430BA5	Bright finish 430 Stainless Steel, .015" thick
304BK5	Black Painted 304 Stainless Steel, .015" thick
304DDJ	Dull finish 304 Stainless Steel, .032" thick
CRGMT5	Matte finish Galvanized Steel, .015" thick
CRTMT5	Matte finish Tinplated Steel, .015" thick
110ML6	Mill finish Copper

Sample Sheet for Ordering

3 - Finish

Color Code	Description
BA	Bright
BK	Black
BL	Blue
CL	Clear
DB	Dark Bronze
BR	Brown
DD	Dull
GR	Green
LB	Lt. Blue
ML	Mill Finish
RD	Red
RG	Orange
VT	Violet
YL	Yellow

4 - Material Thickness

Code	Thickness
0	.010"
2	.012"
4	.014"
5	.015"
6	.016"
8	.018"
A	.020"
E	.025"
J	.032"
K	.035"
M	.040"
P	.050"
R	.062"

5 - Number of Holes

Hole or Slot Code	Hole or Slot Description
000	No holes
109	(1) .093" hole
112	(1) .125" hole
114	(1) .140" hole
115	(1) .156" hole
116	(1) .165" hole
118	(1) .187" hole
121	(1) .216" hole
125	(1) .250" hole
128	(1) .281" hole
137	(1) .375" hole
150	(1) .500" hole
209	(2) .093" holes
212	(2) .125" holes
214	(2) .140" holes
215	(2) .156" holes
216	(2) .165" holes
221	(2) .216" holes
225	(2) .250" holes
415	(4) .156" holes
425	(4) .250" holes
C18	(1) .188" hole in corner
C20	(1) .203" hole in corner
2TN	(2) .188" x .063" slots
1LG	(1) .125" x .500" slot
2RL	(2) .062" x .400" slots
4RL	(4) .062" x .400" slots

Part Number Description Breakdown

Example Part Number: 12304DD5125 (12-304-DD-5-1-25)

- 12 = Tag Part Number (1.06" x 3.50")
- 304 = Material (304 Stainless Steel)
- DD = Finish (Dull)
- 5 = Material Thickness (.015")
- 1 = Number of Holes (1)
- 25 = Hole Size (.250" OD)

Roll of Aluminum Strapping

• Part # T1 = 5/16" x .016" x 85'
Mill finished aluminum

*Works in conjunction with
any slotted tag*

• Part # T2 = 1/2" x .016" x 85'
Mill finished aluminum

*Works in conjunction with
any slotted tag*



- Useful for fastening tags with slots
- Easily cut for application
- 85' per roll

Part Number	Per Case 1-9	Per Case 10-49	Per Case 50-99	Per Case 100+
T1A30ML6085 20 rolls per case .016" x .3125" x 85'	\$210.00	\$201.50	\$197.00	\$193.00
T2A30ML6085 10 rolls per case .016" x .500" x 85'	\$140.00	\$135.00	\$132.00	\$129.00

Retail Pricing For Plant Signage



Quantity:	<100	100+
Black aluminum sign stake with (2) 6-32 holes (sign not included)		
Part Number	Per Unit	Per Unit
Stake 24 24" x .75" x .13" With mounting holes for signs	\$8.50	\$8.00
Stake 18 18" x .75" x .13" With mounting holes for signs	\$8.00	\$7.50
Stake 12 12" x .75" x .13" With mounting holes for signs	\$7.50	\$7.00
.032" non fading dark bronze aluminum signs drilled for rivets		
PS165A52DBJ 2.87" x 4" x .032" with radius corners Holes to match the stakes	\$0.85	\$0.80
PS2A52DBJ3X5 3" x 5" x .032" with radius corners Holes to match the stakes	\$0.90	\$0.85
Laser engraving only (sign not included)		
Custom Engraving (1 side)	\$2.53	\$2.35

■ 3003H14 Aluminum

3003 Aluminum alloy is aluminum alloyed with 1.2% manganese, which increases the strength of the metal over commercially pure aluminum. This alloy has excellent workability, weldability, and corrosion resistance for an aluminum material. It is widely used for drawing, spinning, fuel tanks, sheet metal work, and other applications requiring moderate strength with good workability. It has higher strength than pure aluminum (1100 series).

H14 designates the temper, and indicates that the metal has been strain hardened and partially annealed. In this condition, the metal can be easily formed, with a zero bend radius in thicknesses up to 1/32" thick. Embossing or debossing metal in this temper will not fracture or strain the metal.

■ 5005/5205 Aluminum

This alloy is often referred to as AQ or Anodize Quality aluminum. Alloys in this series possess good welding characteristics and good resistance to corrosion in a marine atmosphere. The major alloying element of this material is magnesium in sufficient quantities to cause substantial lowering of the melting point without producing brittleness in the resulting alloy. When magnesium is used as the major alloying element or with manganese, the result is a moderate to high strength non-heat-treatable alloy.

The 5005 variety is anodized with a variety of organic colors. Long-term exposure to bright sunlight may fade the colors.

The 5205 variety is cobalt salt impregnated, colored on one side only, and available only in black. Long-term exposure to sunlight has shown no noticeable fading.

■ 316 Stainless Steel

Alloy 316/316L is molybdenum-bearing austenitic stainless steel. The higher nickel and molybdenum content in this grade allows it to demonstrate better overall corrosion resistant properties than 304 stainless steel, especially with regard to pitting and crevice corrosion in chloride environments. In addition, Alloy 316/ 316L provides excellent elevated temperature tensile, creep, and stress-rupture strengths, as well as outstanding formability and weldability.

Alloy 316L is the lower carbon version of the 316 and is immune from sensitization, therefore it is very frequently used in heavy gauge welded components.

■ 430 Stainless Steel; 14-18 Chromium

This high chromium, low carbon stainless steel has good mechanical and physical properties, good corrosion resistance to many dilute organic acids and very dilute salt solutions, and excellent resistance to nitric acid. It withstands destructive heat scaling up to about 1550°F.

Type 430, when welded, is susceptible to grain growth with some loss in ductility and toughness. For this reason it is not recommended for welded sections which will be exposed to shock or vibration in service. Because of its strength, toughness, and resistance to heat oxidation, as well as to chemical and atmo-

spheric corrosion, type 430 is used in range oil burners, heat exchanger flues, annealing furnaces, and oil and gas furnace combustion chambers.

Type 430 is magnetic.

■ 304 Stainless Steel; 18-8 Low Carbon

This grade is similar to type 302 except that it has a guaranteed maximum carbon content of 0.08%. The lower carbon content was developed to minimize susceptibility to intergranular corrosion which may result from the carbon separation that takes place in high carbon 18-8 alloys when the metal is heated within the temperature range of 900° - 1650°F. In welding, this temperature gradient is always encountered at a slight distance on each side of the weld, in which area carbide separation takes place.

Type 304 is especially recommended for welded construction where severe corrosive conditions are encountered, such as in the dairy, chemical, paper, and textile industries. This low carbon grade is not ordinarily required for welded construction subjected only to atmospheric conditions.

Type 304 is non-magnetic.

■ Galvanized Steel

This is a standard commercial quality electro-galvanized steel sheet which has been electrolytically zinc coated in coils. Its zinc coating is so completely bonded to the base metal that it will not flake or peel under the most severe forming or drawing operations. It is available with a plain commercial finish not requiring additional processing, or bonderized for enameled, lacquered or painted parts.

Galvanized steel has a silver grey matte finish, generally acceptable on interior parts. Also has good corrosion resistance, again useful for interior parts where added rust protection is required.

■ Electro-Tinplated Steel

This material has a .25# coat, matte finish, and T-1 hardness. It is characterized by excellent forming qualities, and therefore is often utilized for metal plates to be embossed. It also has good paintability, particularly with matte finish. Electro-tinplate is an inexpensive material with excellent properties for stamping applications.

■ 260 Cartridge Brass – Copper, 70%; Zinc, 30%

Cartridge brass, 70%, has excellent tensile strength and is very ductile, being better than Yellow Brass in this respect. It can be subjected to severe cold working in deep drawing, spinning, rolling, stamping, flaring and forming. It is also known as Deep Drawing Brass, Grommet Brass, Spring Brass, and Spinning Brass, indicative of its fabricating qualities. It is ideally suited for the production of artillery and small arms cartridge cases and for musical instruments, snap fasteners, eyelets, reflectors, lighting fixtures, and automobile radiators.

Arboretums and Nurseries

- Plants and species identification
- Tree identification

Automotive

- V.I.N. plates
- Body code plates
- Parts (axles, transmissions, etc.)

Building Construction

- Raw material identification
- Storm door identification
- Window identification

Chemical / Petroleum

- Batch identification
- Offshore drilling identification
- Valve identification

Concrete Products

- Product identification
- Pipe, rebar identification

Commercial

- Tractor trailers
- Farm equipment
- Lawn tractors
- Heavy equipment
- Mine equipment
- Snow making equipment
- Airports

Exporting

- Identification of items
- Crates and containers

Medical

- Instrument identification
- Waste management
- Building management

Mold Inserts

- Rubber and plastic

Nameplates

- Asset plates
- Laser engraved
- Silk screened
- Embossed
- Etch and fill
- Pad printed
- Promotional

Personal

- G.I. Dog Tags
- Bikers, joggers, hikers, etc
- Promotional

Railroad Repair Facilities

- Permanent identification
- Work in process

Recreation

- Trailers
- Recreational vehicle
- Boats
- Small planes

Shipbuilding / Aircraft

- Electrical cable tags
- Tags for overhaul identification
- Signage
- Hydraulic hose identification

Steel Mills

- Coil identification
- Batch identification
- Fabricated part identification
- Rod and wire identification

Utilities

- Cable identification
- Power plant identification
- Utility pole identification
- Valve identification



Definition of Standard Tag

- A standard tag is one shown in this ISG catalog and one that can be made with current tooling. Most "standard" tags will not require a set up fee.
- Anything else is a "Special" tag which will require a quote from the ISG and a possible set up fee (see below).

Set Up Fees

- Any non-standard order will be charged a \$100.00 set-up fee for orders under 5,000 tags. For orders of 5,000 tags and over the fee will be waived.

Minimum Orders

- Minimum order to be \$50.00.

Blanket Orders

- Blanket orders are offered for 12 or 18 month time periods with scheduled release dates pre-determined by the customer.
- Blanket orders require a minimum of 10,000 tags to be ordered.
- Blanket orders require a signed Blanket Order Form and Blanket Schedule Form.

Special Order Requirements

- All special orders must have approved drawings to show hole locations and dimensions.
- All tags or plates to be produced without a pre-existing die will have +/- of .025" tolerance on size and hole / holes location and burr.

Product Labeling

- There is no fee for products shipped with our standard label.
- Fee of \$0.50 cents per box to be relabeled to the customer's requirements. Customer must either supply new labels or submit a sample of their labeling requirements. This fee is waived for blanket orders.

Blind Shipments

- \$5.00 flat fee, above the shipping fee, for all shipments shipped "blind" per customer request. This fee is waived for blanket orders.
- We cannot guarantee blind shipments to be truly "blind" as every package can be tracked back to the original shipper. We will work diligently to fulfill the customer's request.

Shipping

- All below costs are in addition to standard shipping costs.
- Additional \$5.00 flat shipping fee for all ground shipments (up to ten boxes per packing slip). All shipped to one location.
- Additional \$10.00 flat fee for expedited shipments (NDA, 2nd DA) (one time fee per packing slip). All shipped to one location. Orders must be before 3:00 PM (EST).
- Additional \$20.00 flat fee for all UPS, Fed-X and USPS shipments (one time fee per packing slip) for orders taken after 3:00 PM (EST) to be shipped that same day, as requested by the customer. This does not guarantee that the product can be shipped that day.
- \$15.00 pallet fee for all motor freight shipment that requires a non-heat treated pallet (one time fee per packing slip).
- \$10.00 pallet fee for any motor freight shipment that requires a heat treated pallet (one time fee per packing slip).
- \$50.00 pallet fee for all motor freight shipments (one time fee per packing slip) for orders taken after 2:00 PM (EST) to be shipped that same day, as requested by the customer. (This does not guarantee that the product can be shipped that day if ordered too late).



Identification Systems Group
www.IdentificationSystemsGroup.com
info@identificationsystemsgroup.com
888.964.6482

Delivery

- If desired, customers must request shipped product to be insured, as we cannot be responsible for damage occurring during shipment once it has left our facility.
- Delivery for all standard in stock tags is normally one week or less, or as quoted.
- Delivery for all non-standard tags is as quoted.
- We will not guarantee a shipment date (blanket orders excluded), and will not incur expedited fees for any special orders. We will try to accommodate the customer's requests.
- Requests for expedited orders must be sent in writing and will incur an additional fee.

Return Order Policy

- We will accept returns of full boxes of standard tags no later than 60 days after receipt of shipment. A 15% restocking fee will be applied unless we did not make the parts to order specifications.
- We will not accept returns of special items unless we did not make the parts to order specifications.

Sample Order Policy

- We will send samples via the carrier and service of the customer's choosing. If a customer requests expedited samples, the shipping cost will be billed to the customer.
- The price for a partial box of tags will be 20% above retail. These tags will not be offered at a discounted rate.

Disclaimer

- Tags are not guaranteed to be scratch free. We will, however, make every effort to produce a cosmetically mark free product.